

SS4500 STINGER

Owner: SHANGHAI SALVAGE COMPANY

Client: SHANGHAI SALVAGE COMPANY

Country: China

Period: 2016

TECON SOW: Basic design of SS4500 stinger

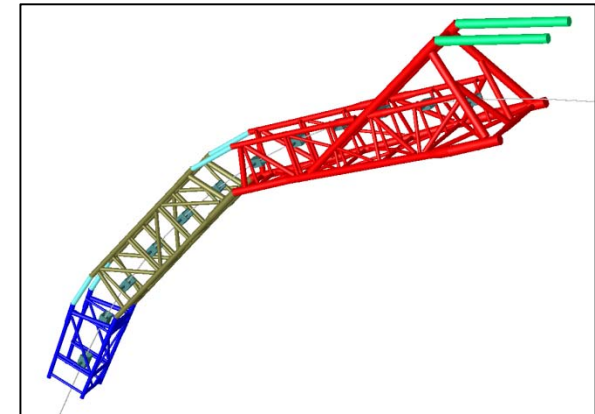

Work description

SS4500 vessel is a heavy lifting vessel that is designed to be equipped with a pipelay stinger. It will comprise three sections with lengths ranging from 51.0 m to 15.5 m to reach a total length of 98.0 m, a total weight of 1150 t and a total number of 12 roller boxes. Depending on the sealine size and water depth, the laying operations can be performed using the whole stinger or a shorter configuration obtained by removing section 2.

Section 1 angle is adjusted by a stinger handling system (SHS). Angles between stinger sections are adjusted by inserting pinned elements of appropriate lengths.

The stinger is designed to allow the laying operations of pipeline ranging from 6" to 48".

Tecon services

- Basic design of the stinger
- Preliminary laying analyses
- Material and fabrication specifications
- Functional specification for pipelay equipment on stinger